



**BATTERY SYSTEMS IN CAR
BODY ENGINEERING**
26 - 27 OCTOBER 2021

**EXHIBITION FLOOR PLAN
AUSSTELLUNGSPLAN**

-  Conference
Konferenz
-  Body-in-white Presentation
Body-in-white Präsentation
-  Booth
Ausstellungsstand
approx. 2 x 3,5 m
-  Clearance Height 1.95 m
maximale Höhe 1,95 m
-  Emergency Exit
Notausgang
-  Lockers
Schließfächer
-  Columns
Säulen

Delivery Zone
for Exhibitors
Anlieferung
Aussteller

Delivery Access
Anlieferung
CONPARC Hotel

Delivery Zone
for Body-in-whites
Karosserie- und
Bauteil-Anlieferung

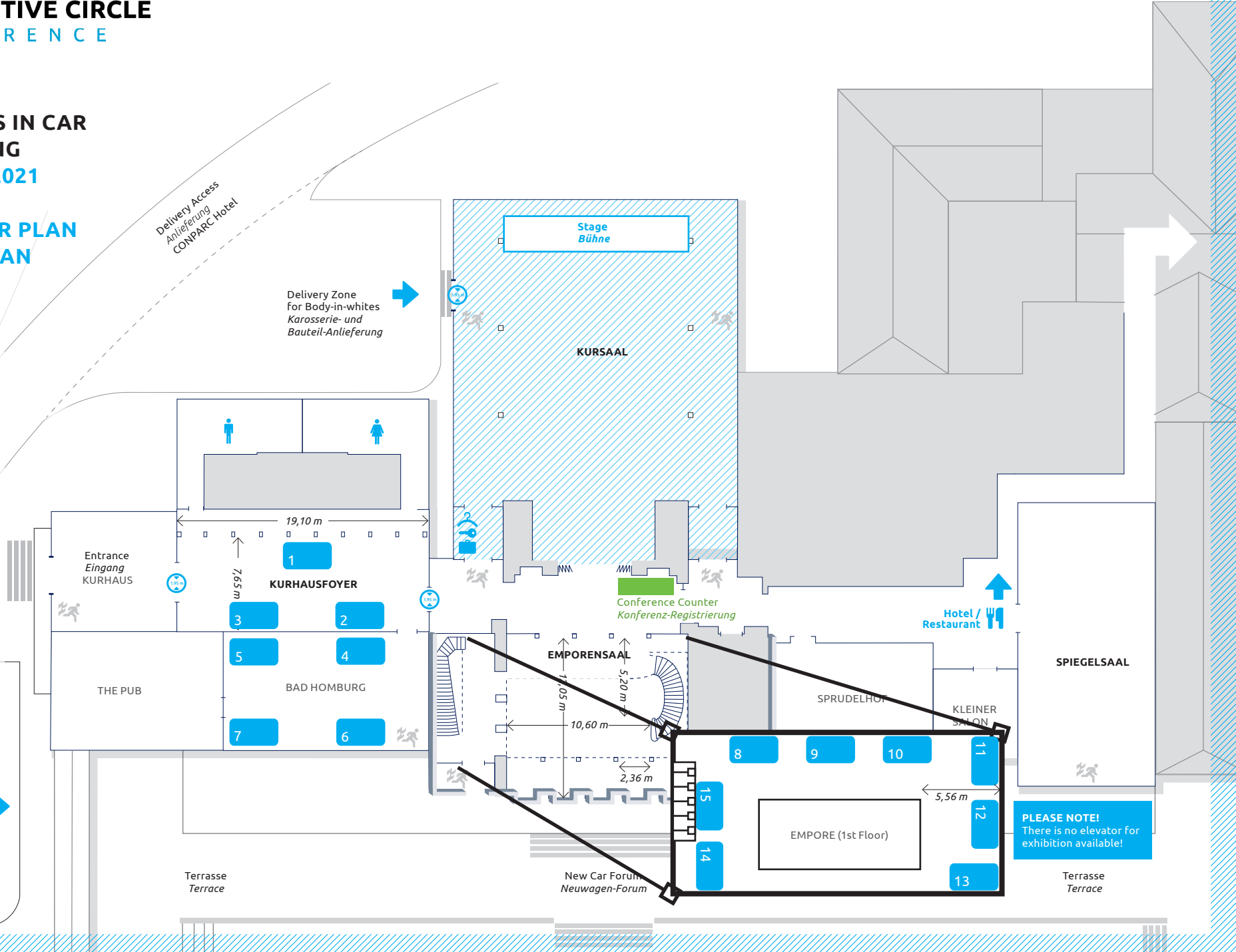

PLEASE NOTE!
There is no elevator for
exhibition available!

Hotel/
Restaurant

New Car Forum
Neuwagen-Forum